

supermarket

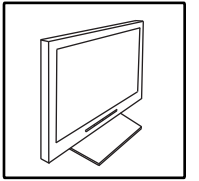

home

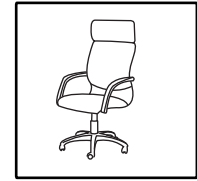
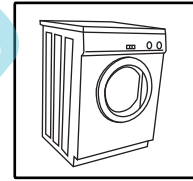
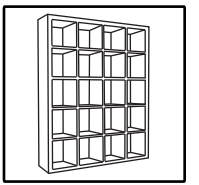
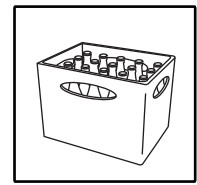
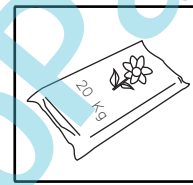

In the future the product range of a supermarket will rise and the closeness to the consumer will increase. But how do I get heavy bulky goods at home without a car? That is what inspired me to create "Rentbee".

The concept is closed to concepts that already exist, like rentable bikes. Several Rentbees are lendable at normal stores and area-wide accessible. Rentbee is designed that collapsed, it can be hung on a wall to three or four to save space. This will also change the look of future inner cities.



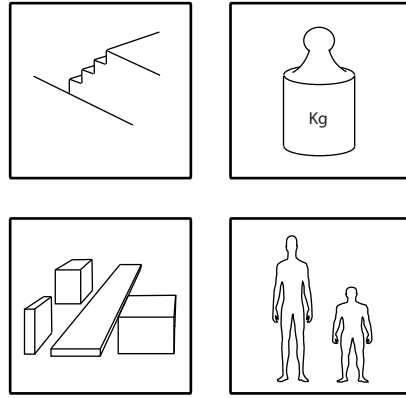

Because of the huge wheels Rentbee can handle nearly every balk like stairs or the break between the train and the floor. The barycentre of the goods is near to middle of the wheel, which makes it easier to transport heavy goods. The handle bar afford nearly every user a comfortable benefit. With Rentbee a multiplicity of goods can be transport. To get an advantage at the manufactory, every component is used more then once.

To lock or re lock the Rentbee, just use your credit card. Parts of the plastics are conducting, there are no cables in it. A backing at the side allows a fast and save parking.

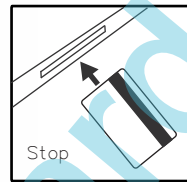
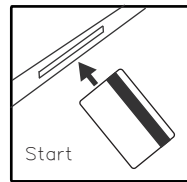

The wheels are laminated with an material which refuse muck. When it is dark, the material also convert the friction energy in light. This is a suspenceful scene and you are seen by other road user.

It is imaginable that Rentbee can also be used as a hanger for bicycle. This can also help to reduce the traffic in inner cities. Optionally conveyances can use Rendbee to sharing out goods more easier.

